

# PICK-UP TIME FRAME

To reach Pick Up location within 30 minutes for  
**Immediate Orders**

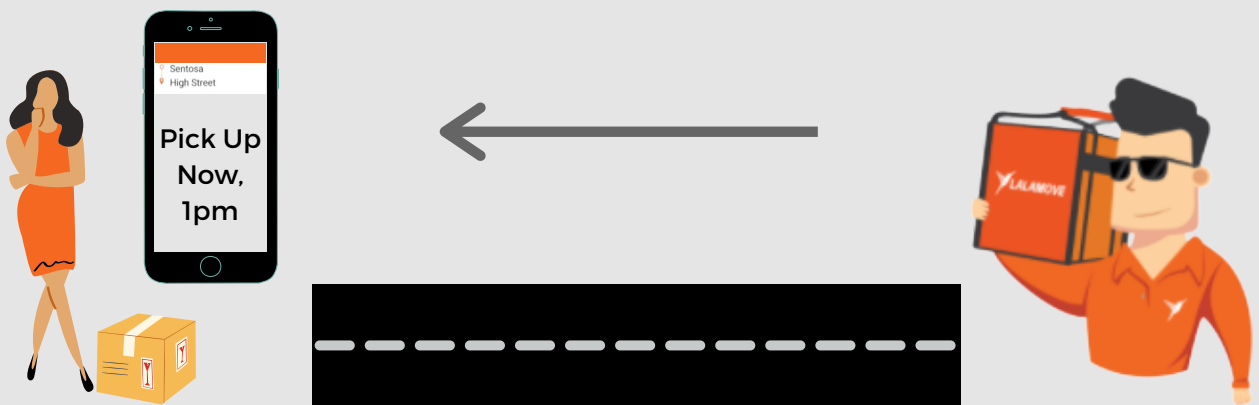

To reach Pick Up location on the stated time for  
**Scheduled Orders**

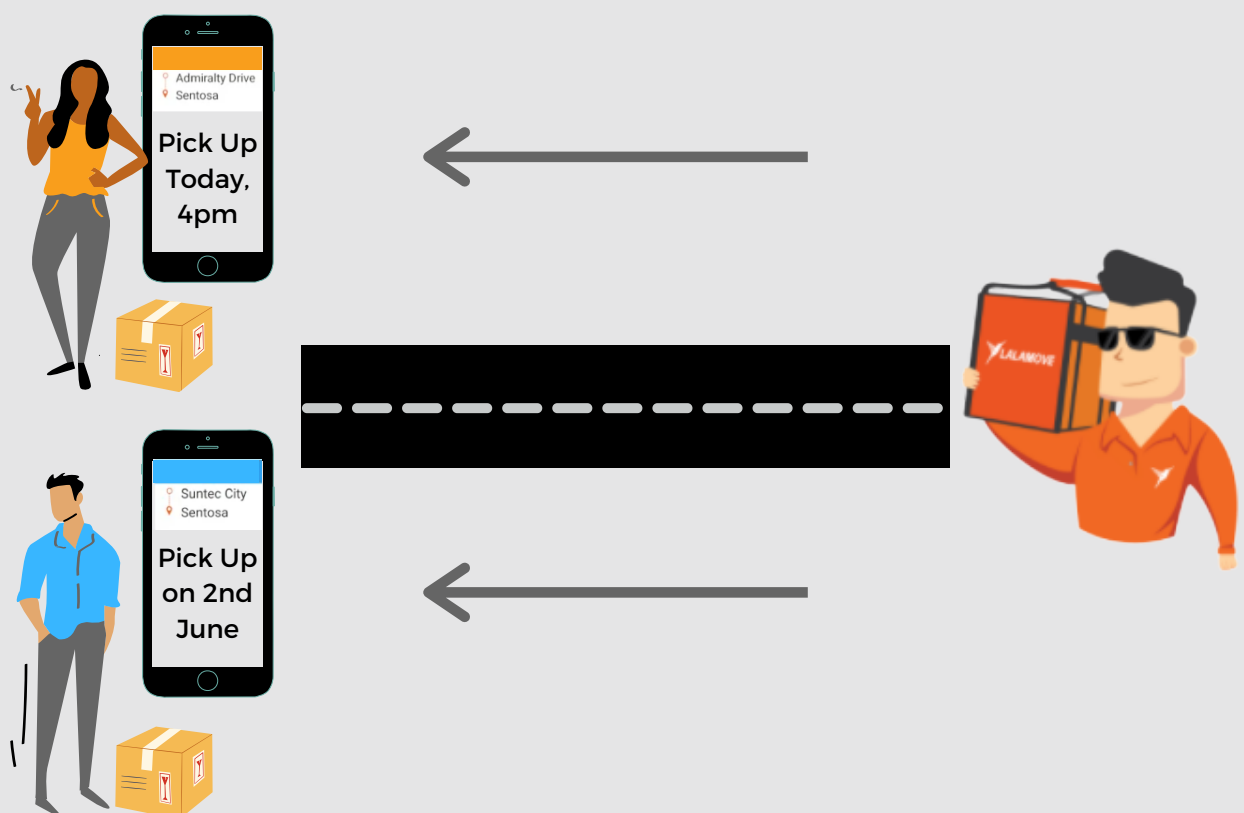

# DELIVERY TIME FRAME

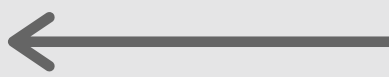

**1 Hour Delivery Time Frame** after Pick-Up for Motorcycle, Car and MPV deliveries



**2 Hour Delivery Time Frame** after Pick-Up for Van and Lorry deliveries

